

TYPE D TOWNHOUSE

C-SECTION 3

1 : 50

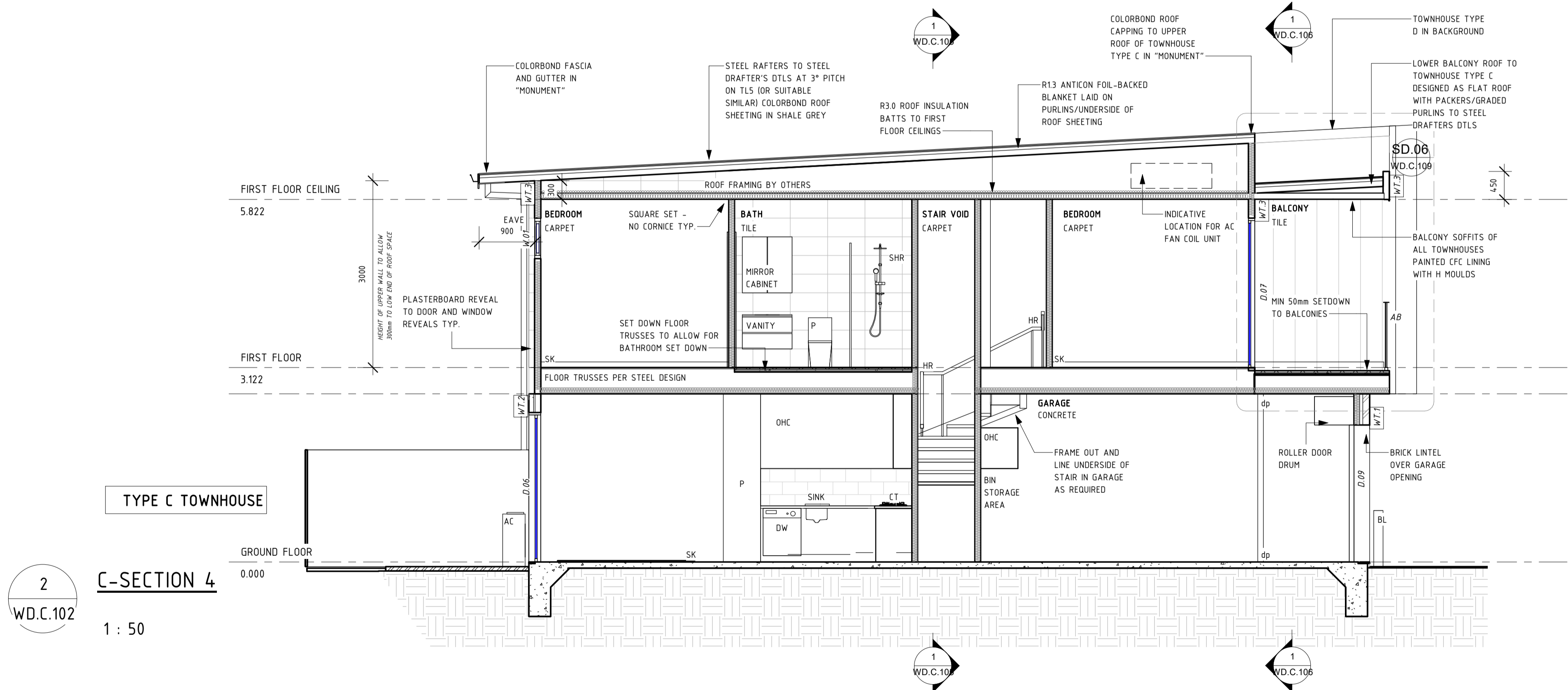

TYPE C TOWNHOUSE

C-SECTION 4

1 : 50

WALL SCHEDULE			
KEY	CONSTRUCTION	INSULATION	FRL
RBW	REFER TO WT6 FOR INSULATION IN EXTERNAL WALLS AND PARTY WALLS	150mm THICK PRECAST PANEL WALL - NATURAL GREY	90/90/90
WT.1	BRICK VENEER WALL ON 92mm STEEL STUDS TO DRAFTER'S LAYOUTS, 50mm CAVITY, FLUSHED AND PAINTED 10mm PLASTERBOARD INTERNALLY.	R2.5 90mm BRADFORD GW INSULATION (OR EQUIVALENT) TO ALL EXTERNAL WALLS	60/60/60
WT.2	HEBEL POWERPANEL WALL ON 25mm TOP HATS FIXED TO 92mm STEEL STUDS TO FRAMING LAYOUTS, FLUSHED AND PAINTED 10mm PLASTERBOARD INTERNALLY.	R2.5 90mm BRADFORD GW INSULATION (OR EQUIVALENT) TO ALL EXTERNAL WALLS	60/60/60
WT.3	FIBRE CEMENT CLADDING DIRECT FIXED TO 92mm STEEL STUDS TO FRAMING LAYOUTS, HARDIE SCYON TO SOUTH AND NORTH 1ST FLOOR WALLS, RENDERED AND PAINTED CFC TO OTHERS, FLUSHED AND PAINTED 10mm PLASTERBOARD INTERNALLY. USE 2 x LAYERS 13mm FIRE RATED PLASTERBOARD TO LINING OF TOWNHOUSE 13.	R2.5 90mm BRADFORD GW INSULATION (OR EQUIVALENT) TO ALL EXTERNAL WALLS	--/--/--
WT.4	BORAL PARTI-WALL SYSTEM (PWT60.1A) 25mm SHAFTLINER WITH 20mm CAVITY BOTH SIDES, THEN 92mm STEEL STUDS TO FRAMING LAYOUT DETAILS, FLUSHED AND PAINTED 10mm SOUNDSTOP PLASTERBOARD INTERNALLY.	R2.0 GW INSULATION TO ALL EXTERNAL WALLS	60/60/60
WT.5	HEBEL BOUNDARY WALL. 25mm CAVITY BETWEEN HEBEL WALLS, HEBEL PANEL EACH SIDE OF CAVITY, SECOND SIDE TO BE FIXED INTERNALLY VIA CLIP SYSTEM, FIXED TO 92mm STEEL STUDS TO FRAMING LAYOUTS, AND FLUSHED AND PAINTED 10mm PLASTERBOARD INTERNALLY. USE 13mm PLASTERBOARD TO TOWNHOUSE 13.	R2.0 GW INSULATION TO ALL EXTERNAL WALLS	60/60/60
WT.6	STANDARD INTERNAL STEEL STUD 92mm WALLS, PAINTED AND FLUSHED PLASTERBOARD EACH SIDE	R2.0 GW INSULATION BATTS TO INTERNAL WALLS	--/--/--

This drawing shows design features and dimensions of a building. It is not to be used for construction without the approval of the designer. It is the responsibility of the designer to ensure that the building is constructed in accordance with the design. The designer is not responsible for any errors or omissions in this drawing.

REVISIONS		
ISSUE #	DATE	DESCRIPTION
PD1	15/04/2019	PRELIMINARY WORKING DRAWINGS
PD2	23/04/2019	ISSUE FOR BRC APPROVAL
A	30/07/2019	FOR BRC & TENDER
B	22/03/2020	ISSUE W.D.B + W.D.C. TOWNHOUSES FOR CONSTRUCTION

PROJECT ADDRESS  
82 - 90 JOHNS ROAD, PROSPECT SA  
5082

CLIENT  
82 JOHNS ROAD PTY LTD



SHEET  
SECTIONS 03

WD.C.107

AUTHOR  
GB

CURRENT REVISION  
ISSUE W.D.B + W.D.C. TOWNHOUSES FOR CONSTRUCTION

ISSUE DATE  
22/03/2020

FOR CONSTRUCTION

